



Get a Grip Box Bag Template Directions

No Slipping ~ No Kidding!



I have several videos showing how the Box Bag Template is used to create some great projects. They can be found at www.youtube.com/Lindavideos. Click on Playlists then Winner Designs. Scroll through to find 6 videos. Or click the links below.

Box Bag Videos:

- Pt 1 - <https://www.youtube.com/watch?v=DgYMqrnz2s8&index=8&list=PLIzgfFmf8SoUUhwGMym6Yy2tzYr1Zeco7>
- Pt 2 https://www.youtube.com/watch?v=zm0e_rGFiaq&list=PLIzgfFmf8SoUUhwGMym6Yy2tzYr1Zeco7&index=13
- Fabric - <https://www.youtube.com/watch?v=2KfVuLNUiXs&index=14&list=PLIzgfFmf8SoUUhwGMym6Yy2tzYr1Zeco7>
- Cut - <https://www.youtube.com/watch?v=HYOin6CmUKQ&index=15&list=PLIzgfFmf8SoUUhwGMym6Yy2tzYr1Zeco7>
- More - <https://www.youtube.com/watch?v=snFOGnu8sZU&list=PLIzgfFmf8SoUUhwGMym6Yy2tzYr1Zeco7&index=16>
- Moms - <https://www.youtube.com/watch?v=nx169mSJFo8&index=5&list=PLIzgfFmf8SoUUhwGMym6Yy2tzYr1Zeco7>

I call this template a 'Bag Box'...
It's shaped like a house and offers so much variety and is loads of fun!

Depending on the type of interfacing, (medium weight interfacing or none at all), it could be a cute little bag or purse. But by just changing the interfacing and cutting a few more 'houses', it could turn into a storage box!
Or use wipe-able fabric (PUL) and it's a perfect sandwich bag...
Add a pocket or two and some straps and turn it into a necklace bag.
Use the template to make smaller or larger bags to turn it into a business card/gift card holder or a clutch.

Be sure to watch my online [videos](#) and read through all of the directions before starting any of these projects~

BTW - I'm left handed, so the pictures and videos are from a left-handed perspective.
For right-handers; sorry. For left handers - you're welcome!



Seam Allowance: The Box Bag Template was designed to be used with a 1/4" seam allowance but adjust as needed. When creating the Box and Bag projects, you'll see a note about seam allowances so that the Inside fits nicely.
Note: Many of the pictures are distorted due to way I took the pictures - please forgive my photography!

Sandwich Bag/Envelope Style Bag - a Bag First & then a Box

The Box Bag Template is perfect for a sandwich bag. Or... it could be a cute, little envelope style bag to hold coupons, papers, or even a little gift. Add box pleats or leave it flat for an envelope look.



Decide if you'll use a Tupperware-type container made to hold sandwiches or if you'll just use saran wrap around your sandwich. If you decide to use a container, I recommend buying several because they differ in size. The one I originally purchased was not as 'fat' as the one shown in the picture. When I made the bag and added the Velcro, I made it to fit the first container. Now that I've lost that container, the one that I bought to replace it is bigger and the Velcro doesn't close as nicely it should. If you have a larger container, it's easy enough to add an inch or two. See further below and my video for how.

The seam allowance for the Sandwich Bag is 1/4" except where noted. When stitching the lining, you'll use closer to a 3/8" seam allowance.

You need:

Outside Fabric - 2 Scraps at least 8" x 11" each
Lining Fabric* - 2 pieces of PUL or other fabric at least 8" x 11" each
Basic Sewing Supplies, Sewing Machine
Straight Pins or Clips (Clips won't leave holes in the PUL fabric)

Cutting Mat, Rotary Cutter
Iron*, Turning Tool
Snaps, Velcro, Button or Magnets
Teflon or Roller Foot if using PUL

Fabric Choices:

*PUL is a type of laminated fabric. It's waterproof, breathable and wipeable. Find it on-line and at fabric stores like JoAnns. DO NOT iron PUL. For more on PUL, go to: www.diapersewingsupplies.com/how-to-sew-pul-fabric/

In the pictures above, I only used PUL on the lining. Below on the camouflage and forest animals bag, I used PUL for both the inside and outside. I don't recommend this for your first time because PUL is a bit slippery and 2 layers of PUL are big-time slippery! A Teflon foot will definitely help. For the first time, use cotton fabric for the lining and outside fabrics or cotton for the outside and PUL for the lining.





Cutting the Back/Flap Piece:

Unlike the box bag, you won't cut 4 pieces for the outside and 4 for the lining. Instead, you'll cut 2 house shapes (1 outside fabric, 1 lining fabric) with the template for the back/flap piece.

Cutting the Front Piece:

You'll use the template to create the front piece (1 outside fabric, 1 lining fabric) but you won't cut the point. This will create the square pocket opening.

Let's get started!

 <p>Cut the Back/Flap Pieces (house shape): Layer lining fabric and outside fabric wrong sides together and place the template on top. PUL is slippery so you'll have to be more careful than if you were working with other fabrics. Cut completely around the template to create 2 house shapes.</p>	 <p>Cut the Front Pieces(square): Layer the lining fabric and outside fabric wrong sides together and line them up straight on a line on your mat.</p>	 <p>Place template on top so that the point is down and 1/2" away from the edge of your fabrics. Cut the 3 sides to create 2 squares.</p>
 <p>After cutting, you'll end up with 1 house & 1 square of the outside fabric and 1 house & 1 square of the lining fabric.</p>		

Sewing:

 <p>Line up your edges and use straight pins or clips to hold fabric in place. (Pins will leave holds so pin up & down not left & right.) Left - outside fabrics Right - lining fabrics</p>	 <p>Outside Fabrics: On the outside fabric, sew the sides and bottom together, using 1/4" seam allowance.</p>	 <p>The outside fabrics should look like this, using 1/4" seam allowance.</p>
--	---	--



Lining:

Here's where you won't use a 1/4" seam allowance. With a 3/8" or 1/2" seam allowance, sew the sides and bottom, leaving about a 2 1/2" opening in the bottom. A wider seam allowance will make the lining fit nicely into the outside pieces.



This is what you'll have after you've sewn the 2 sections.



Turn the lining piece right sides out. Don't sew up the opening yet, we'll need it to turn again.



The lining has been turned right sides out but we've left the outside piece alone.



Tuck the lining into the outside piece. The lining should fit nicely inside the outside piece.

Adding Velcro or Magnets:

If adding Velcro or magnets, this is the time to add to the pointed flap. Adding now means it won't show on the outside flap but it also means that it'll only be sewn on the inside layer.

Snaps & buttons can be added later so they're a better choice since you won't have to guess at the placement.

Velcro can be added later but stitches will show on the outside flap. Add a piece of ribbon or fabric as embellishment.



Pin around the opening and the point and stitch with a 1/4" seam allowance.



This is how it should look.



Reach inside and find the opening of the lining. Pull so that the right sides of all pieces are showing.



Work to push out all fabrics. This will take some time. If using PUL fabric, DON'T use an iron. If using other fabrics, give everything a good press.



Take a look at your bag and make sure everything looks good and that the lining fits nicely.



Decide if you are happy with the bottom of the bag or if you want to add box pleats as shown below.

This bag can be a great little envelope bag to hold coupons, paper, etc.



Adding Box Pleats:

Pull the lining out and turn wrong sides out. At the bottom, take 1 corner and make a point on the side, feeling that the side seam and bottom seam are lined up.



Pin. About 3/8" to 1/2" up from the corner, stitch across.



Repeat the process for the other side of the lining. Here's what it will look like from the bottom.



Turn right sides out. Make sure you're happy with your box pleats. If not, pull wrong sides out and fix them!



If you're happy with the box pleats, cut off the excess fabric. Leave the opening area open.

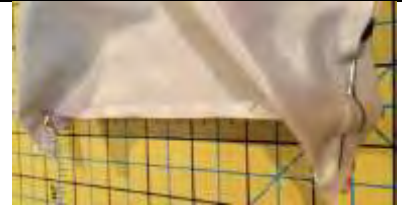

Now, pull the bottom part of the outside fabric so that you have the wrong sides are showing. Repeat the process but make the box pleat a little larger than the lining.



About 1/2" - 5/8" up from the corner, stitch across. Repeat for the other corner.



Here's what it should look like when you've sewn the box pleats.



Turn right sides out. Make sure you're happy with your box pleats. If not, pull wrong sides out and fix them!



If you're happy with the box pleats, cut off the excess fabric.



From the opening of the lining, pull so that the right sides of all pieces are showing.



Work to push all edges out. This will take some time. If using PUL fabric, DON'T use an iron.



If using other fabrics, this would be a good time to give everything a good press.



Pinning is not recommended here because they might leave holes in the fabric.
Top stitch close to the edge, working the seam so that the edges are nice



Topstitching completed...



Now we're ready to close the opening section. You can sew by hand, use a fabric glue or ...



stitch it closed where the stitching shows - it's inside so it won't matter!



Push the lining back into the bag so that the bottom box shows off those nice box pleats.



Almost finished....



A perfect bag for those perfect little kids of yours or for yourself....



It's best to do this earlier, but I stitched on Velcro dots on the point and below. As long as you're adding a button or some closure on the outside, the stitching won't show. The bottom dot was harder to sew but with enough 'finagling', it can be done.



Adding a Closure:

If you're going to use a tupperware-type container, place inside and mark where you'll place your closure. Add your button, snap or velcro.

That's it! Go fix yourself a big sandwich, stuff it in your sandwich bag and go somewhere.... then eat it!



You could always add a pre-made strap to dress it up a bit.

Necklace Bag



This cute little bag is perfect to wear around your neck when traveling or when you don't want to carry a purse. It's the perfect size for those basics: a cell phone, glasses, keys, lipstick and a few dollars and a credit card.

It's made exactly the same as the Sandwich Bag except that you can add pockets and a strap. The hardest thing about this bag is to decide on your closure!



Iron on a stabilizer to outside pieces. Cut 2 outside pieces & 2 lining pieces as above. To add a back pocket, take a larger piece of fabric, fold in 1/2 & place batting, felt or fleece inside folded piece.

Missing picture showing the outside layer, pocket and template

Before cutting with the template, top stitch along the folded edge of the pocket that contains the batting, felt or fleece. Then place the outside layer down right sides up then place the pocket in position with right sides up.

Place template on top of these layers and cut.

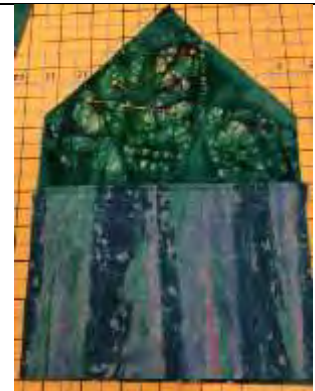

Here's outside layer with pocket.

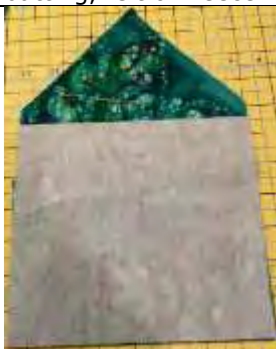

Pin all 3 pieces of the outside layers together – back flap, pocket, then outside square.



Stitch the lining and the outside layers just like the Sandwich Bag. The only difference will be the additional thickness from the outside pocket.

Turn as in the Sandwich Bag. I chose not to add box pleats to the Necklace Bag. It's up to you!

Complete the process as shown above.



Add a strap. Stitch 1 out of fabric or use cording or a pre-made strap. Measure to determine length. Most of strap in pic is tucked inside the bag.



This shows the back pocket.



Here are a variety of buttons and dangles that can be used as closures. You can use Velcro, snaps, magnets, buttons or just even the weight of a dangle might work.

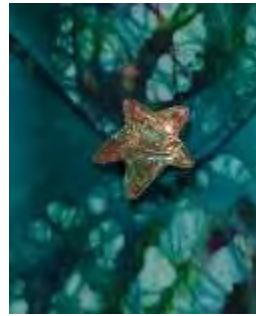

Close-ups of some closures



This strap was cut to be worn cross-body. Tie a knot in the strap to wear as a necklace bag.

The jewelry tassel was stitched into the point. Because it's so heavy, there was no need to add Velcro to hold the flap down.

If you do want to add Velcro and a tassel, be sure to add the Velcro early on so the stitches won't show on the flap.

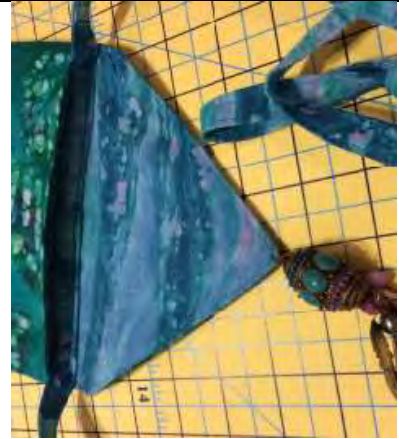

Want to make a taller bag?



Use another ruler and your mat to add height to squared off edge of the template for the Outside layers then cut as usual. For the Inside layers, decide how much you want to add in height. Cut straight down, using a straight edge or moving the template down if needed.

Want a Larger or Smaller Bag?



There are so many envelope style bags... it's up to you to decide the size and shape and what to do with them! The sewing process is exactly the same as the Sandwich Bag and the Necklace Bag so directions will focus on the cutting part rather than the sewing part.

Please forgive my poor photography skills! Pictures are distorted. Sides are actually straight rather than angled.



For this, I used batting to give more loft. Place the 2 pieces of fabrics with wrong sides together and add a layer of batting. Fold all layers in half. Smooth out fabric so there are no bumps or wrinkles.

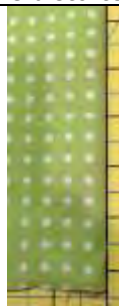

Line up the folded edge to a line on your mat.



Place point of template on fabric fold. Make sure template edge without fabric is lined up straight on mat. (Picture is distorted & doesn't show this!)



Cut 1A
Making sure that the point of template is on the fold of fabric, cut along edge of template.



Cut 1B
Using mat as a measurement, move template directly to the left. Finish the cut along edge of template.



Cut 2A
Cut up the side.



Cut 2B
Move template straight up same amount as in 1B. Finish cutting the rest of the side.



Cut 2B
Finish the cut along the edge of the template.



Cut 3
Cut along top edge of template. Fabric is on the fold so you won't need to move template for this cut.



Refer to Sandwich Bag directions for details. Pin lining layers together and outside layers together and sew.



Turn lining fabric wrong sides out and tuck inside outside pocket. Stitch around point and opening area. Turn right sides out and play around with the edges so that it takes on the shape of the bag. Top stitch around rights sides of point and opening area. Sew closed the turning area.

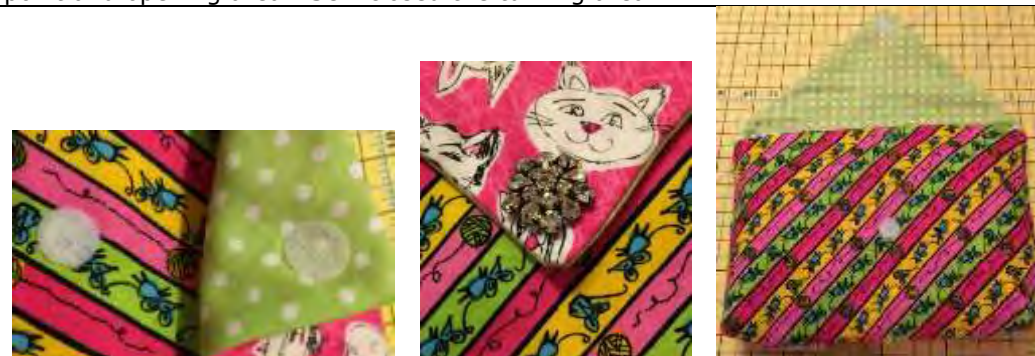

Straps are a nice option for a larger bag. I might add some later....
Decide on your closure. The button used will cover up the stitches used to attach the Velcro dot.

Business Card Holder/Simple Wallet – Want a Narrower Bag?



The Box Bag Template is the perfect height for a Business Card Holder. This easy way to cut will waste just an inch or two of fabric but it's fast and accurate.

Cutting a Narrower Shape with the Box Bag Template







Lay out your fabric: batting, inside wrong sides up, outside right sides up. Cut along the base of the house. Turn the template with the fabric and cut 1 side. Turn and cut 1 point. Turn and cut the next point. Turn and cut the last side. You'll have your house layers.



Place your template back on top of the fabric layers but don't line it up with the edge of your fabric. Use your mat and place the template anywhere from 1/2" – 1" from the edge of the fabric. Cut. Turn the template with the fabric and line up the fabric on your mat again. Pick up the template and line it up with the same amount cut from the first cut. Cut. The Mermaid Wallet was cut 1/2" smaller on each side. The Hopt Lips Business Card Holder was cut 3/4" smaller on each side.



<p>You'll use the height of the template but not the width. Iron a piece of stabilizer onto the inside fabric or, as with the mermaid, use batting.</p>	<p>Sew right sides together using ¼" seam allowance, leaving the bottom open to turn.</p>	<p>Turn right sides out and press well. Turn the bottom unsewn area in and press. Stitch it closed. Again, apologies for the distortion!</p>
 <p>Fold the bottom up and pin in place.</p>	<p>If you're adding Velcro, now's the time. The stitches on the front flap will show where you attach the Velcro so be sure you have a closure that will cover up the stitches. The easiest way to determine the Velcro placement is to stick the 2 Velcro dots together. Place the dots on the point area. Holding them in place, fold the flap down and decide where you want the bottom Velcro dot to go. Separate the 2 dots and pin the bottom one in place. Unpin the bottom folded area so you can easily sew the dot in place. You can sew the top dot in place now or wait until after sewing the side seams.</p>	 <p>Pin the sides again. You can topstitch around the whole project but I chose not to. Stitch each side down, ensuring that you backstitch well at the starts and ends.</p>
 <p>Both Velcro dots are sewn in place.</p>	 <p>Here, you can see the side seams sewn down and the Velcro dot attached.</p>	 <p>Add a pair of hot lips to cover up any stitches from below. You're finished!</p>

Box Bag Box Project – this is much easier to understand in the video than in writing so watch my video to see this process!



The Storage Box is basically the same as the Bag. A stiffer fabric, interfacing or something like plastic canvas is needed for the box if you want it to stand up on its' own. The bag works best with a softer, flowy fabric and straps.

In the step by step Box directions, I've used 2 different blue jeans (pockets came from lighter colored blue jeans). For the inside, I used scraps made when practicing free motion quilting but any material will do. If using another type of fabric for the lining, you'll use an interfacing to add substance.

You will need:

Outside Fabric - 4 Scraps at least 8" x 11"

Cutting Mat, Rotary Cutter

Inside Fabric - 4 Scraps at least 8" x 11"
Or several fat quarters for outside fabric & inside fabric
Med or Heavy weight interfacing, 2/3 yard, 20" wide

Basic Sewing Supplies & Sewing Machine
Iron, Turning Tool

Decide on the amount of stiffness you want for your box. There are many types of stabilizers available so you may want to try a few to see what offers the amount of stiffness you want.

Seam Allowance:

I typically use a 1/4" seam allowance but since we're doing an Outside section and an Inside section, I recommend a scant 1/4" seam when sewing the Outside section and a scant over 1/4" for the Inside section. Or you can use a scant under 3/8" for the Outside & a scant over 3/8" for the Inside. This will help the Inside fit nicely inside the Outside section.

Cutting with the Box Bag Template:

Check out my videos on the Box bag Template at www.youtube.com/Lindavideos or www.WinnerDesigns.com/videos.

Because this template has the Get a Grip material on the back, you'll cut differently than with other templates you might typically use for a project like this – acrylic, paper, freezer paper, Mylar, etc. The get a grip material grabs the fabric so you can cut knowing that the template won't slide around on the fabric! That means that you can cut many more layers than you would typically. No slipping; no kidding!

You'll need 4 outside pieces and 4 lining pieces. If you're using an iron on interfacing, iron it onto the outside fabric before cutting.

Yardage

If using yardage, I fold the outside fabric into smaller segments and cut out 4 layers at a time. Place the template on top and cut the 4 sides. Repeat the process for the lining fabric.

Scraps

If using scraps, choose 8 that are large enough and stack the 4 that will be the outside together right sides out. Place the template on top and cut one side. With your hand still on the template, turn and cut the next side. Notice in the pictures that the template and fabric have been repositioned. The beauty of the get a grip is that it stays with the fabric so you turn as you cut. Your cutter stays in the same position making all cuts consistent! Continue until all 4 sides are cut. Repeat the process with the lining fabric.

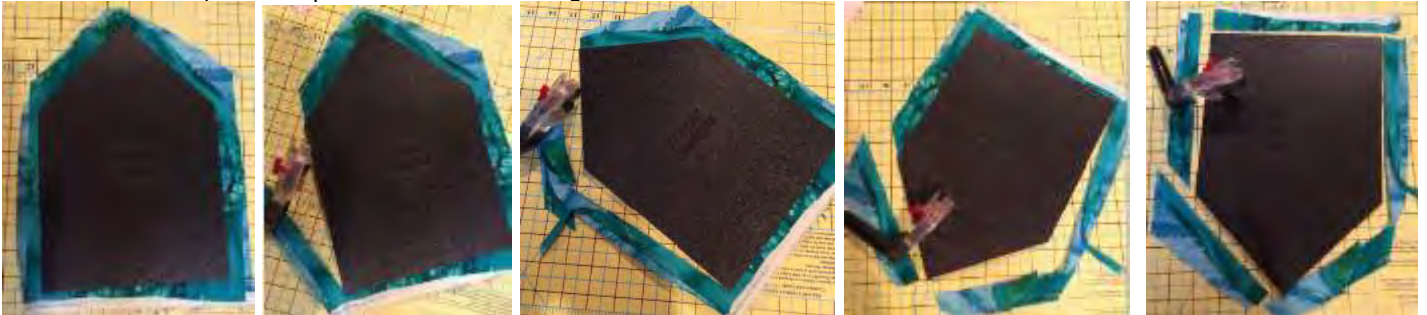

Do this for both the Outside section and the Inside section fabrics. You'll have 4 pieces of each fabric; 8 in total.

Fat Quarters

The pictures below show the process for 2 fat quarters. I ironed the interfacing/stabilizer onto the fat quarters and then stacked the fat quarters wrong sides together. I cut the 2 layers at a time and reposition the template 3 more times to cut out 8 pieces ending up with 4 pieces for the lining and 4 for the outside.

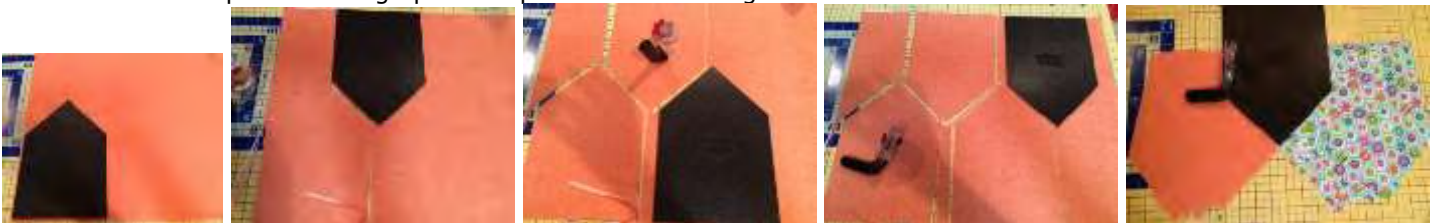



Here's another example of a Fabric Box:



Thanks for your purchase! I hope you enjoy this template~ Questions, suggestions? Feel free to call or e-mail.

Do you do Facebook? 'Like' me at www.Facebook.com/LindaWinnerDesigns.com & look for my specials & giveaways!

I'd love to see what you do with this. If you share pics and a comment, I'll give a 20% discount on your next Winner Designs purchase. Just let me know before you order~

To see my other templates go to www.WinnerDesigns.com and click on my Products Retail Sheet on the Homepage. For videos, go to www.youtube.com/Lindavideos, click on Playlists then Winner Designs or go to www.WinnerDesigns.com and click on Videos.

Care & Handling of Template:

- The Get a Grip material must be kept free of accumulation of dirt, thread, etc.
- Store template with Get a Grip face up or in accompanying bag. Get a Grip will stick to painted surfaces.
- If Get a Grip material gets dirty, clean with light amount of soap & water, hand sanitizer, or window cleaner.
- My favorite cleaning method is to lightly press the area with a cheap piece of packing tape.



By Linda Winner

Mouserme@yahoo.com

850-449-0259

www.WinnerDesigns.com